

Marshall Electronics, Inc.
 1910 East Maple Avenue
 El Segundo, CA 90245

INFORMATION ON THIS DOCUMENT IS PROPRIETARY
 AND SHALL NOT BE USED, COPIED, REPRODUCED, OR
 DISCLOSED IN WHOLE OR IN PART WITHOUT WRITTEN
 CONSENT.

V-LH21

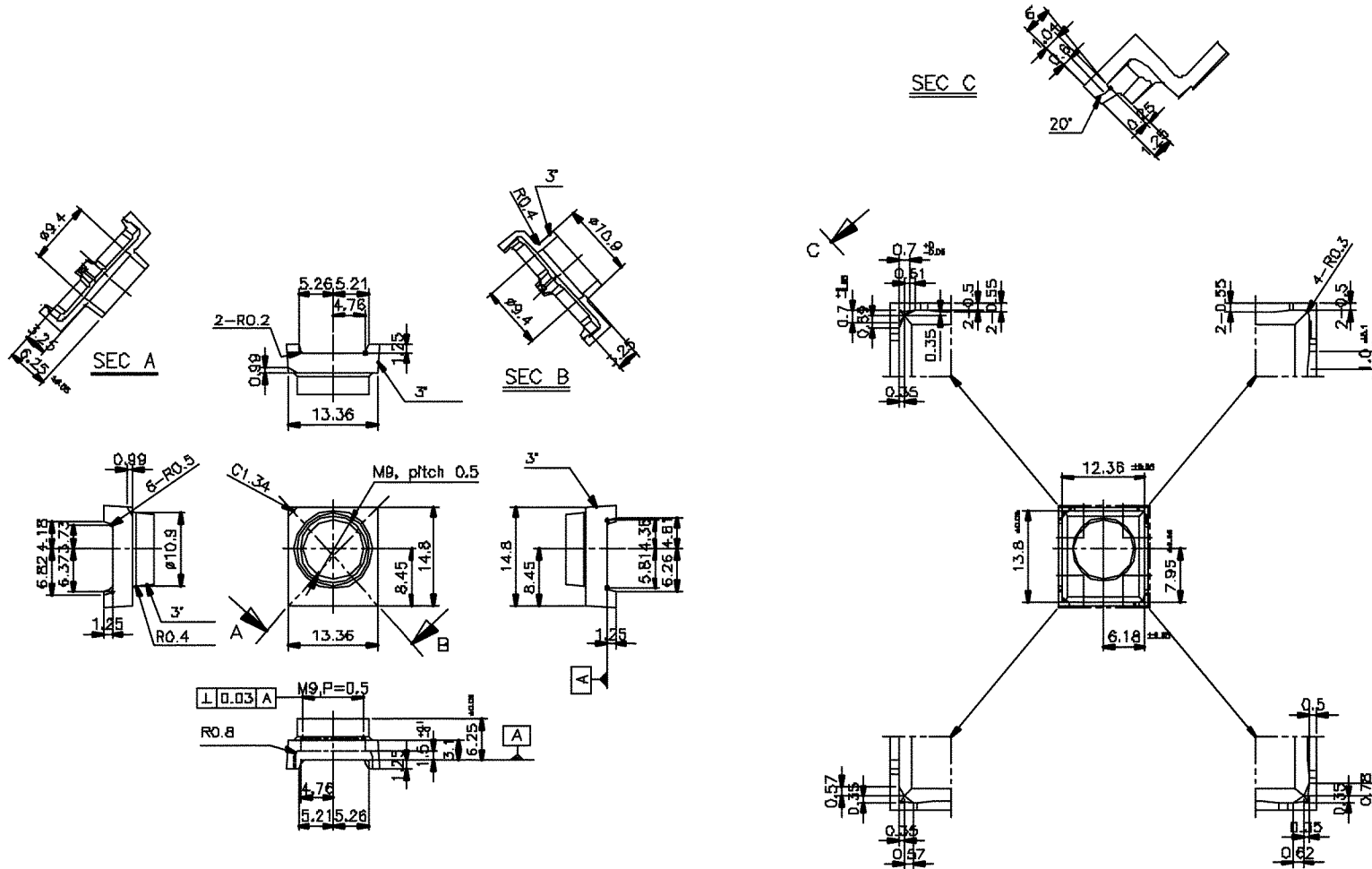

TOLERANCES (mm) FOR PLASTIC
 INJECTION MOLDED PARTS:

FEATURE SIZE	TOLERANCES (mm)			
	0-20	20-100	100-200	200~
XX.	±0.5	±0.7	±1.0	±2.0
XXX	±0.2	±0.3	±0.5	±1.0
XXXX	±0.1	±0.2	±0.3	±0.8