

# 3.8mm (FT Type)

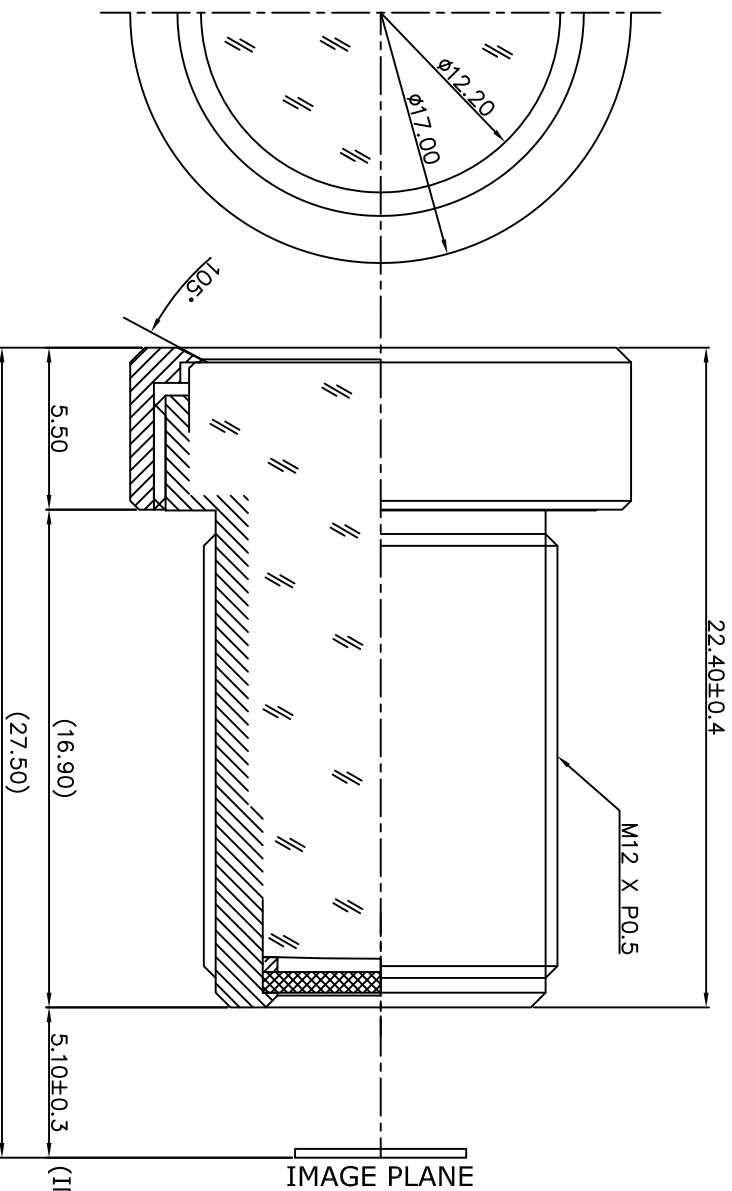

1. SENSING AREA : 1/2.8" 2Megapixel CMOS
  2. FOCAL LENGTH : 3.85MM ± 5%
  3. BACK FOCAL LENGTH : 6.76MM ± 5% (IN AIR)
  4. MAXIMUM RELATIVE APERTURE : 1.4 ± 5%
  5. IRIS : FIXED
  6. LENS CONSTRUCTION : 6 COMPONENTS 6 ELEMENTS
  7. ANGULAR FIELD OF VIEW : DIAGONAL : 105°  
HORIZONTAL : 85.9°  
VERTICAL : 51.9°
  8. FILTER : BUILT IN 650nm±10nm IR-CUT FILTER
  9. IMAGE CIRCLE DIAMETER :  $\phi$ 7.2
- ( IT IS CHANGEABLE ON EXTERNAL DIMENSION BY CUSTOMER'S REQUIREMENT.)

A4	Scale	N/S		Dwg No.	DATE	2016.01.15	REVISION NO.				
								<table border="1"> <tr> <td>TOLERANCES</td> <td>Designed</td> <td rowspan="3">Title</td> <td rowspan="3">Monofocal 3.8mm Lens F/1.4 Low Illumination</td> </tr> <tr> <td>ANGLE 1°/2</td> <td>Checked</td> </tr> <tr> <td>X. ± 0.2</td> <td rowspan="2">Approved</td> </tr> <tr> <td>.X ± 0.1</td> </tr> <tr> <td>.XX ± 0.05</td> <td></td> </tr> </table>	TOLERANCES	Designed	Title
TOLERANCES	Designed	Title	Monofocal 3.8mm Lens F/1.4 Low Illumination								
ANGLE 1°/2	Checked										
X. ± 0.2	Approved										
.X ± 0.1											
.XX ± 0.05											